

# Highways

Highways Commissioning  
Block 5, 6<sup>th</sup> Floor East  
Shire Hall  
Gloucester GL1 2TH

08000 514 514

[AshDieback@gloucestershire.gov.uk](mailto:AshDieback@gloucestershire.gov.uk)

---

Our reference: 11289262

Friday, October 16, 2020

## **Ash Dieback: A429 Fosseway, Donnington**

Dear Sir/Madam

What: Temporary Traffic Order to **close the road** for essential Ash Dieback tree work.  
Where: A429 Moreton-in-Marsh to Stow-on-the-Wold – see overleaf for details of the exact location  
When: 4<sup>th</sup> November to 10<sup>th</sup> November 2020 (excluding weekends), from 09.30 to 15.30 daily

On behalf of Gloucestershire County Council, we will shortly be carrying out essential works at the above location in order to remove unsafe trees infected with Ash Dieback.

Ash Dieback disease causes Ash trees to become unsafe, and the tree could shed limbs or collapse on to the road causing harm and injury. This work must take place for health and safety reasons, to protect road users and pedestrians, and make sure the carriageway remains clear of debris.

### **ROAD CLOSURE**

We will be carrying out essential tree works at the above location for health and safety reasons to protect users of highways and county council land as part of our Ash Dieback project. To ensure the safety of you and our work force we have, under Sections 14, 15 & 16 of the Road Traffic Act 1984 as amended, made a Temporary Traffic Order to **close the road**.

Due to the type of activities required with tree felling and maintenance works, the road closure can cover an area greater than where work is taking place. This is to allow safe movement and placement of machinery and material.

We appreciate road closures are inconvenient, but it is necessary to keep you and the team working on the road safe. We have planned the work so we can be in and out as quickly as possible and have tried to do it at a time that will minimise any inconvenience.

### **ACCESS**

In accordance with the Temporary Traffic Order, we are not permitted to allow any person or vehicle to proceed along the closed roads; with the exception of emergency vehicles, statutory undertakers responding to an emergency situation. We will endeavour to keep the public foot path open at all times, if it is necessary to close it at any point it will be for a limited time and fully supervised by our trained banks man.

Therefore, if you normally drive into or out of this area during the hours when the road closure is in place, we ask you to please make alternative arrangements.

# Highways

In exceptional circumstances, some level of access may be considered. This will be on a case by case basis and only where it doesn't impact on our ability to carry out the work and where it is safe to do so. Any access during this time would be at the drivers own risk as it is a works site.

## DIVERSIONS

We have created an official diversion route which will be signposted and is suitable for all vehicles that would normally use the closed road. We appreciate you may know an alternative route, however please be aware alternative routes which are outside of the road closure area are used at driver's discretion.

## Parking

If you usually park within the road closure, you will need to find alternative parking nearby during the hours the road is closed.

## Contact us

If you have any queries please refer to the Frequently Asked Questions leaflet delivered with this letter, or contact us on 08000 514514 or email [AshDieback@gloucestershire.gov.uk](mailto:AshDieback@gloucestershire.gov.uk). Below is a map showing the extents of the road closure.

Thank you in advance for your patience and co-operation.

Yours faithfully,



Sara Noons  
Ash Dieback Officer

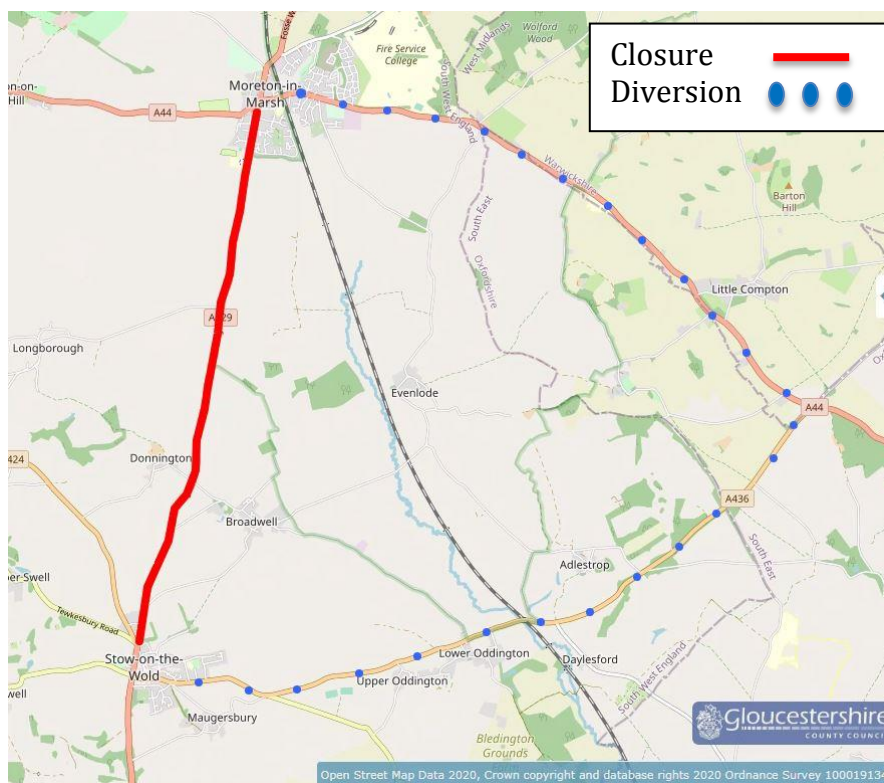

\*Access to North Cotswold Hospital / Main Cottage Surgery / Fosseyway Garden Centre from Moreton-In-Marsh.

## Ash Dieback Road Closures – your questions answered

It is often necessary for us to temporarily close a section of road for essential maintenance work. We close the road for safety reasons and also to get the work done as quickly as possible.

You are receiving the following information because you live or work on a section of road that is due to be temporarily closed in the near future. We hope this will help answer any questions you may have. Properties immediately affected by the road closure should have received a letter with further details. If not please contact [Highways@Gloucestershire.gov.uk](mailto:Highways@Gloucestershire.gov.uk)

| Question  | Answer   |
|---|--|
| Will we be able to drive back and forth from our property while the road is closed?   | As the work involves felling of trees and large equipment, we will be unable to allow traffic through the <b>Road Closure</b> . If you normally drive into or out of the Road Closure during the hours when the closure is in place, we ask you to please make alternative arrangements. In exceptional circumstances, some level of access may be considered on a case by case basis but only where it does not impact our ability to undertake the necessary works and where it is safe to do so.  |
| Can I walk through the road closure?  | We will endeavour to keep the public foot path open at all times to maintain access to properties within the road closure, if it is necessary to close it at any point it will be for a limited time and fully supervised by our trained banks man.  |
| Why can't you do these works at night?  | We always consider night working as an option but it is often not feasible due to environmental restrictions related to noise, particularly in residential areas.  |
| Where am I expected to park while the road is closed?   | If you usually park within the <b>Road Closure</b> , you will need to find alternative parking nearby during the hours of the road closure. There is a possibility that your vehicle may be towed out of the area if it is obstructing the works.  |
| I'm expecting a delivery to my home during this period – will it get to me?   | Delivery drivers are often happy to park nearby and use pedestrian access to make their delivery. Vehicle access through the <b>Road Closure</b> will not be possible, therefore to avoid disappointment please consider rearranging any deliveries for after the work is finished or outside of the road closure hours.   |
| We are a business, how will staff / customers / deliveries be able to get through?  | Please encourage staff, customers and deliveries to access the business outside of the Road Closure hours. If this is not possible, please encourage staff and customers to park nearby and use the pedestrian access. In exceptional circumstances, some level of access may be considered on a case by case basis but only where it does not impact our ability to undertake the necessary works and where it is safe to do so.  |
| I'm disabled and need vehicular access to my property – can this be accommodated?   | In exceptional circumstances, some level of access can be considered on a case by case basis but only where it does not impact our ability to undertake the necessary works and where it is safe to do so. Please call our Customer Contact Centre with details of your circumstances or, if work is already underway please let our gateman or site manager know your circumstances and they will do what they can to assist.   |
| We are expecting home visits from a carer / district nurse / midwife during this period – will they be able to get through? | Please let your carer / district nurse / midwife know about the road closure as they may need to allow extra time for the visit in case of delays. It is likely that vehicle access through the Road Closure will not be possible, therefore it is suggested that visitors park outside of the road closure and use the pedestrian access. Please call our Customer Contact Centre with details of your circumstances or, if work is already underway, please let our gatemen know of any expected visits in advance and they will do what they can to assist. |
| This road is on a bus route, what will happen to the buses while the road is closed?  | We notify the bus companies about road closures well in advance, they will have arranged alternative routes. Please contact your bus operator for more details.  |
| How will be our rubbish and recycling be collected with the road closed?  | Your refuse collector will have been advised of the closure in advance. Often collection will take place on your normal collection day, however very early in the morning - please ensure your waste is out by 6am. You may want to check with your refuse collector for specific details.   |
| Why does the diversion route have to go so far?   | Official diversion routes that use roads of an equivalent classification will be signposted. This allows HGV's and buses to be confident that the roads are suitable for them in terms of weight restrictions and low or narrow bridges.   |
| How are you going to stop traffic from using the road past my house?  | Official diversion routes will be signposted that use roads of an equivalent classification that are suitable for weighted vehicles such as HGV's and buses. With regards to local traffic movements, we have no authority to stop individual road users from deciding to use alternative routes outside of the road closure.  |

### Any other questions?

Call us on 08000 514 514 or email [Highways@gloucestershire.gov.uk](mailto:Highways@gloucestershire.gov.uk)

You can also report issues at [www.gloucestershire.gov.uk/reportit](http://www.gloucestershire.gov.uk/reportit)

Last Updated June 2020.



@GlosRoads



@GloucestershireRoads